

R 1200 / 1250 RT-P Harness Connections

MY 2015 forward

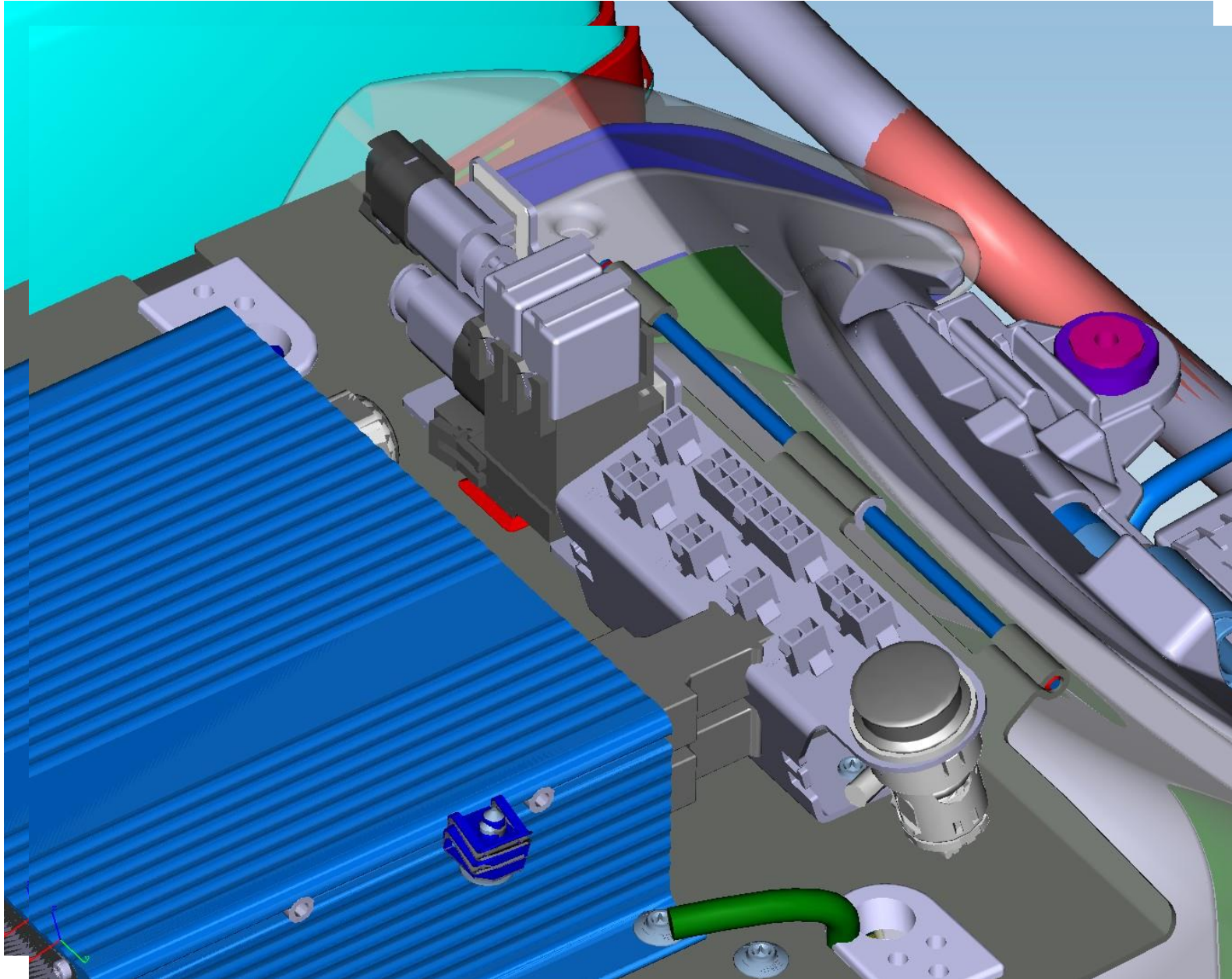

R 1200 / 1250 RT-P Harness Connections

MY 2015 forward

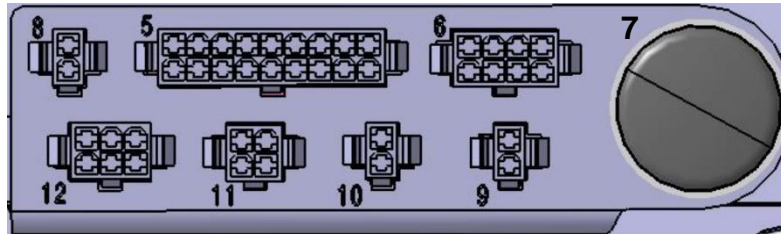
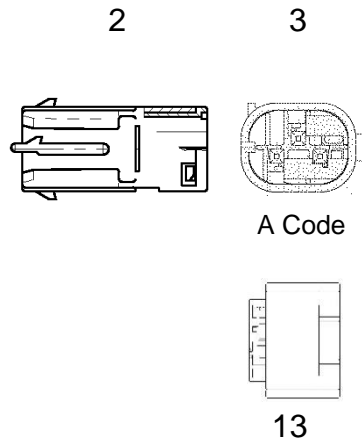

MY15-18

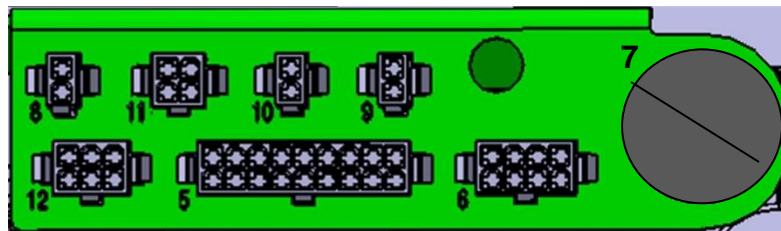

MY19+

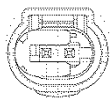

1

- 1-Gun Lock (6A) (under radio box floor plate)
- 2-Radio (15A)
- 3-Auxiliary Rear LED Lights
(mounting location only)
- 4-Relays (radio power, radio speaker cut-out)
- 5-LED Flasher Connection (10A + 6A)
- 6-Helmet Headset Interface (2A)
- 7-Lighter Socket (6A)
- 8-Accessory I (2A)
- 9-Accessory II (2A)
- 10-Accessory III (2A)
- 11-Radar Connection (6A)
- 12-Fairing Speakers
- 13-Euro PA Microphone Connection
(parallel connection to PA in plug #6)

R 1200 / 1250 RT-P Harness Connections

MY 2015 forward

Radio Box Connections

1-Gun Lock, 6A

X1716 <https://fmsaccessories.com/sealed-bmw-connector-sets>



- 1 Power Gun Lock (from Pin 46 – 6A, 30 seconds after activation) GR RS
- 2 Ground BR

2-Radio, 15A

ET865 <https://fmsaccessories.com/radio-connection-plug-code-a>



- 1 Radio Power + (from relay controlled by GMSF Pin 9, 0.3A, 30 min. after ign. off) RT SW
- 2 Radio Ground BR

3-Auxiliary Rear Duplex LED

(holder clip only)

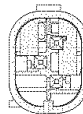

See Flasher Diagram

4-Relays

K73

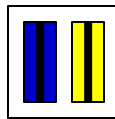

Relays for **Radio** & **Fairing Speaker Cut-out**

8-Accessory I

ET884 <https://fmsaccessories.com/accessory-i-iii-connection-plugs>



- 1 Auxiliary I (GMSF Pin 33 – 2A, 60 seconds after ign. off) GN RT
- 2 Ground BR

5-LED Flasher Input

ET381



See Flasher Diagram

6-Helmet Headset Interface

ET1715 <https://fmsaccessories.com/helmet-headset-connection-plugs>



- 1 F1 PTT Switch Signal (GMSF Pin 23 – 0.65A, momentary, 30 minutes after ign. off) SW GR
- 2 F2 PTPA Switch Signal (GMSF Pin 34 – 2A, momentary, 30 minutes after ign. off) SW RT
- 3 Headset Interface Power (GMSF Pin 20 – 2A, 30 minutes after ign. off) SW VI
- 4 Ground - BR
- 5 Side Stand Extended Signal (direct connection to MC side stand switch in harness) GR GN
- 6 Microphone NF to Siren PA
- 7 PTT + to siren PA (do not activate directly from F2 pin 2 or increased noise will result)
- 8 PTT 2 Switch Signal (GMSF Pin 21 – 0.6A, momentary; 30 minutes after ign. off) SW GN

R 1200 / 1250 RT-P Harness Connections

MY 2015 forward

Radio Box Connections

7-Accessory Lighter Socket

ET1427 <https://fmsaccessories.com/printer-power-connector>



- 2 Accessory Power (GMSF Pin 3 – 6A, 30 minutes after ign. off / shared with Radar Plug) RT VI
- 1 Ground BR

9-Accessory II

ET1711 <https://fmsaccessories.com/accessory-i-iii-connection-plugs>



- 1 Auxiliary II (GMSF Pin 35 – 2A, 25 minutes after ign. off) GN WS
- 2 Ground BR

10-Accessory III

ET885 <https://fmsaccessories.com/accessory-i-iii-connection-plugs>



- 1 Auxiliary III (GMSF Pin 36 – 2A, 30 minutes after ign. off) GN BL
- 2 Ground BR

11-Radar, 6A

ET1712 <https://fmsaccessories.com/radar-connection-plug>



- 1 Radar Power (from Pin 3 – 6A, 30 minutes after ign. off) RT VI
- 2 Ground - BR
- 3 Vehicle Speed Signal GR GE (harness line contains a 10KΩ resistor)
- 4 Siren Video Trigger Signal + GR RT

12-Fairing Speakers

ET380 <https://fmsaccessories.com/speaker-connection-plugs>



- 1 LH Fairing Speaker + GE RT
 - 2 LH Fairing Speaker - GE BR
 - 4 RH Fairing Speaker + BL GE
 - 5 RH Fairing Speaker - BL BR
- Fairing Speaker Cut-Out BL VI
(GMSF Pin 7 – 2A, 30 minutes after ign. off)

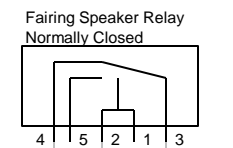

- 3 Auxiliary Wires BR GE
- 6 Auxiliary Wires SW GE



X1717
Bundled by front
right frame by horn
mount.

TE 2-Position
Code A

Plug for extension wires near Handlebar
(2-position pin housing Code A)

<https://fmsaccessories.com/sealed-bmw-electrical-connector-sets>

R 1200 / 1250 RT-P Harness Connections

MY 2015 forward

Other Electrical Connections

13-Euro PA Microphone Connection Plug

<https://fmsaccessories.com/sealed-bmw-connector-sets>

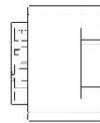

- 1 Supply Voltage Power + GR SW
- 2 Push-To-Talk BL GE
- 3 Microphone NF to Siren PA SW VI
- 4 Ground - WS BR

Front Accessory USB Socket (dealer installed option)

<https://fmsaccessories.com/fairing-usb-outlet-w-voltmeter-on-off-switch>

Cigarette
Lighter
or USB
Socket



- 1 Ground - BR
- 2 Front Power Plug + (duplicate from front power socket or fused harness) RT GN

Front Lighter / USB Socket

X98 <https://fmsaccessories.com/fairing-waterproof-lighter-socket>



- 1 Ground - BR
- 2 Front Power Plug + (duplicate from front power socket) RT GN

Fused Front Socket Harness

(dealer installed option)

<https://fmsaccessories.com/front-fused-power-socket-harness>



- 1 Ground - BR
- 2 Front Power Plug + (Fused Direct Power from Main Battery) RT

Map Light Plug @ Steering Head

ET1718 <https://fmsaccessories.com/sealed-bmw-connector-sets>



- 1 Map Light + (GMSF Pin 47 – 2A, 30 minutes after ign. off) GE
- 2 Ground - BR

Mating BMW Power Socket Plug

<https://fmsaccessories.com/power-socket-male-plug>



Connect to heated clothing or other 12v DC electrical needs

R 1200 / 1250 RT-P Harness Connections

MY 2015 forward

LED Lighting System

Light Connections Inside Rear Housing on Flasher Board

- LH Rear Side LED
- LH Rear LED / Cruise
- RH Rear LED / Cruise
- RH Rear Side LED
- LH Side Turn Signal
- RH Side Turn Signal
- Rear Brake / Tail Light
- Rear Blue ID LED Lights
- Saddlebag Lights

Flasher Dip Switch Map

- 1-Flash Actuation Grouping
- 2-Enable Alley Lights with warning Lights
- 3-CA LH Front Warning Light
- 4-Bootloader (to reprogram if needed)



LED Flasher in Rear Housing

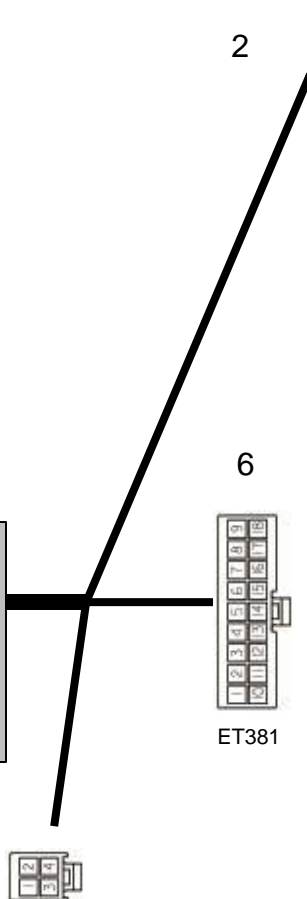

1	LH Auxiliary Rear LED Light	
2	RH Auxiliary Rear LED Light	
3	Ground	
1	LH Front Side LED SW BL	1
2	LH Alley LED SW BR	2
3	LH Front Forward LED / Cruise SW GE	3
4	LH Front Take Down Light SW GN	4
	LH Ground BR	7
	Not Used	5, 6, 8
5	RH Front Side LED WS BL	1
6	RH Alley LED WS BR	2
7	RH Front Forward LED / Cruise WS GE	3
8	RH Front Take Down Light WS GN	4
9	Rearward LED Indicator Light (red) GE OR	5
10	Forward LED Indicator Light (amber) GE VI	6
	RH Ground BR	7
	Not Used	8
11	LIN-bus VI WS	
	InterClear® Signal from Siren	
	Cruise Light Switch (I)	
	Alley Light LH Switch (C)	
	Alley Light RH Switch (D)	
	LED Light Activation (P)	
	Take Down Light – Steady Burn (E)	
	Take Down Light – Wig Wag (F)	
12	Emergency Light Power Source (GMSF Pin 5, 10A), 30 minutes after ign. off GN RT	
13	Take Down Light Power Source (GMSF Pin 2, 6A), 30 minutes after ign. off GR RT	
14	Brake / Tail Light GR SW GE	
15	Left Side Turn Signal BL RT	
16	Right Side Turn Signal BL SW	
17	Ground BR	
18	Ground BR	

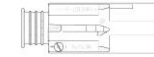

Rear Auxiliary Light



Left Front Lights



TE 106527-8

Right Front Lights



TE 106527-8

6



Video Connection Plug

<https://fmsaccessories.com/video-system-icon-plug>

- 1-LH Turn Signal
- 2-RH Turn Signal
- 3-Rear Brake
- 4-Rear Emergency Lights

R 1200 / 1250 RT-P Harness Connections

MY 2015 forward

LED Lighting System – LAPD Harness

Light Connections Inside Rear Housing on Flasher Board

- LH Rear Side LED
- LH Rear LED / Cruise
- RH Rear LED / Cruise
- RH Rear Side LED
- LH Side Turn Signal
- RH Side Turn Signal
- Rear Brake / Tail Light
- Rear Blue ID LED Lights
- Saddlebag Lights

Flasher Dip Switch Map

- 1-Flash Actuation Grouping
- 2-Enable Alley Lights with warning Lights
- 3-CA LH Front Warning Light
- 4-Bootloader (to reprogram if needed)



LED Flasher in Rear Housing

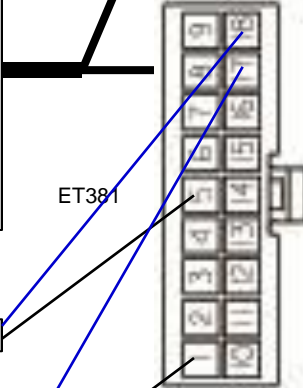

Connect with LH Rear Side LED

Connect with RH Rear Side LED

1	LH Auxiliary Rear LED Light
2	RH Auxiliary Rear LED Light
3	Ground

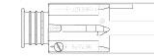

1	LH Front Side LED + RH Rear Side LED BL SW	5
2	LH Alley LED SW RT	2
7	LH Front Forward LED / Cruise SW WS	3
8	LH Front Take Down Light SW	4
	LH Ground BR	
	Not Used	
5	RH Front Side LED + LH Rear Side LED WS SW	1
6	RH Alley LED RT	6
3	RH Front Forward LED / Cruise WS	7
4	RH Front Take Down Light GN	8
9	Rearward LED Indicator Light (red) OR	9
10	Forward LED Indicator Light (amber) OR SW	10
	RH Ground BR	
	Not Used	
11	LIN-bus RT WS	11
	InterClear® Signal from Siren	
	Cruise Light Switch (I)	
	Alley Light LH Switch (C)	
	Alley Light RH Switch (D)	
	LED Light Activation (P)	
	Take Down Light – Steady Burn (E)	
	Take Down Light – Wig Wag (F)	
12	Emergency Light Power Source (GMSF Pin 5, 10A), 30 minutes after ign. off GR	12
13	Take Down Light Power Source (GMSF Pin 2, 6A), 30 minutes after ign. off VI	13
14	Brake / Tail Light BL	14
15	Left Side Turn Signal BL WS	15
16	Right Side Turn Signal RT SW	16
17	Ground BR	17
18	Ground BR WS	18



General Module SF Controller System Output Allocation

Pin Location	Amps	Running Time*	Description
34	2A	30 min	F2, PTPA Switch Output (H) SW/RT x1715
35	2A	25 min	Accessory II Power Source GN WS x1711
36	2A	30 min	Accessory III Power Source GN BL X885
47	2A	30 min	Map Light GE x1718
2	6A	30 min	TDL Power Source GR RT A381
1	6A	30 min	Siren Power (power stays on 30 min for PA)
9	0.3A	30 min	Radio Power Relay (FUNK) BL WS x865
8	0.6A	30 min	Power Supply P-Switches
21	0.6A	30 min	PTT 2 (license reading) SW GN x1715
3	6A	30 min	Radar Power Source + Cig. Lighter RT VI x1712
22	0.3A		Not Used
23	0.65A	30 min	F1, PTT Output (G) SW GR x1715
7	2A	30 min	Radio Speaker Mute Switch output to Speaker Relay
20	2A	30 min	Helmet Headset Interface Power Source SW VI x1715
46	6A	30 sec	Gun Lock Power Source (hold power on for 30 seconds – lapse after ignition is off) GR RS x1716
37			Authority Relay
51	0.3A		Battery Voltage Measurement
5	10A	30 min	Emergency Lights Power Source GN RT a381
33	2A	30 sec	Accessory I Power Source + Radio Box Power Unlocking System GN RT x884

*after ignition off

Handlebar Switch Identification Diagram

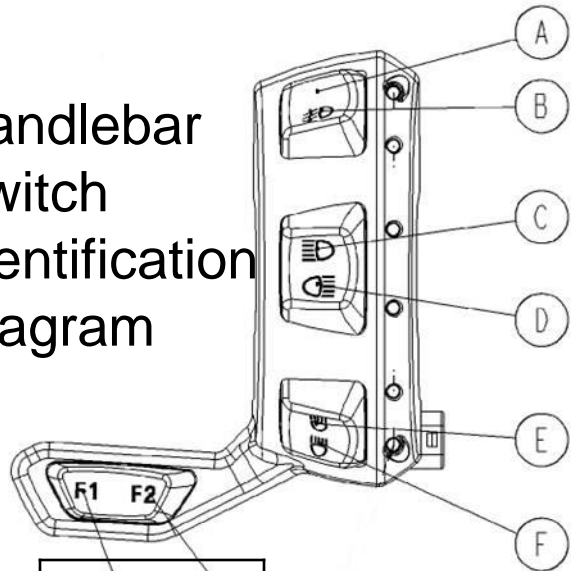

BU Behörde USA
(c) BC1,BC2,BC3,BC5, BC9,
BC20, BC35, BC36, BC47

	X113A
A (Taster)	(T) BC21
B (Taster)	wie Serie
C (Schalter rastend)	auf LIN
D (Schalter rastend)	auf LIN
E (Schalter rastend)	auf LIN
F (Schalter rastend)	auf LIN
(F1) G (Taster)	(T) BC23
(F2) H (Taster)	(T) BC34 (m)
I (Taster)	auf LIN
J (Taster)	(R) SW
K (Taster)	(intern) SW
L (Taster)	(R) BC7
M (Taster)	(intern) SW
N (Taster)	(T) BC46 (40s)
(F3) O (Taster)	auf LIN
(F4) P (Taster)	auf LIN
Hupe	auf LIN

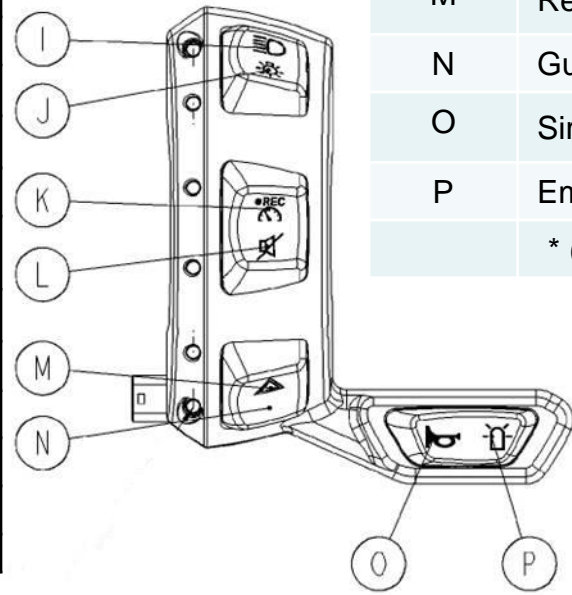

Ref	Description	Type*	Indicator
A	PTT 2	T	-
B	Auxiliary Headlight	T	-
C	Alley Light – Left	R	Blue
D	Alley Light – Right	R	Blue
E	Take Down Light – Steady Burn	R	Green
F	Take Down Light – Wig Wag	R	Red
G	Push-To-Talk	T	-
H	Push-To-PA	T	-
I	Cruise Light (US not X114A) no BCA	T	Yellow
J	Headlight “OFF”	T	Green
K	BC Speedometer Speed Lock	T	-
L	RH Radio Speaker Mute	T	Blue
M	Rear Two-Way Flashers	T	Red
N	Gun Lock “OPEN”	T	-
O	Siren Activation	T	-
P	Emergency Light Activation	T	-

* (T)entative Switch (push-button) (R)ocker switch, stay in position